

Susan Phillips

From: Susan Phillips
Sent: 05 October 2022 14:07
To: harry dike
Subject: RE: Proposed definitive map modification: part of bridleway 33 Stourton Caundle (N54/33)

Dear Mr Dike

Thank you for your email regarding the Definitive Map Modification Order T721 for Stourton Caundle.

Your comments are gratefully received and will be held on file along with other information and comments gathered during the consultation period. At the end of the consultation period a report is written which will include relevant information received from interested parties.

Would you like to be notified when this report is available? Should the answer be 'yes' please be aware that it can take many months between a consultation concluding (which for this particular case is due to be 7th November) and the report being made available. This is due to the potentially lengthy nature of investigations for DMMOs as well as the checking process and potential legal review that the report must go through.

Thank you once again for contacting me with your knowledge of the route for DMMO T721.

Kind regards
Sue

Sue Phillips
Definitive Map Technical Officer
Definitive Map Team
Economic Growth and Infrastructure
Dorset Council

01305 221409
dorsetcouncil.gov.uk



Dorset Council is a Data Controller for the purposes of the General Data Protection Regulation 2016. This Act regulates how we obtain, use and retain personal information. The information you supply will be used for the purpose of fulfilling our functions and duties, including those under the Highways Act 1980, Town and Country Planning Act 1990 and the Wildlife and Countryside Act 1981. Any information provided, including personal details will be available for public inspection, disclosed to interested third parties and may be used during public inquiries and other proceedings. The information will be kept indefinitely. By replying to this correspondence you are consenting to your personal information being retained and used for these purposes. Further information about the use of personal information and data protection is available on our web-site at www.dorsetcouncil.gov.uk or by contacting the Council's Data Protection Officer.

From: harry dike [REDACTED]
Sent: 05 October 2022 13:10
To: Susan Phillips <susan.phillips@dorsetcouncil.gov.uk>
Subject: Proposed definitive map modification: part of bridleway 33 Stourton Caundle (N54/33)

Dear Susan, the letter regarding the above numbered modification to the definitive map has been brought to my notice.

06.10.22	Telephone call	<p>Mr Michael Young – part property owner of Rowden Mill Farm. Telephoned me in response to consultation letter. He supports the correction of the Drafting Error and does not wish to prevent people being able to use the route. He believes the route should run diagonally from the footbridge north west to the edge of the plot owned by Rowden Mill House based on what he has seen on historical maps. Mr Young will send me copies of historical maps he holds of the area in support of the correction of the map.</p> <p>Mr Michael Young's telephone number [REDACTED]</p>
----------	----------------	--

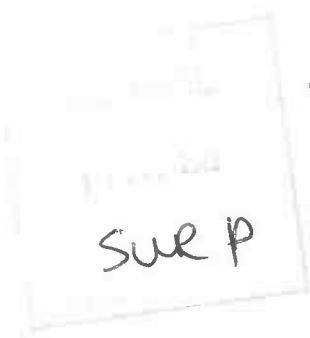

The Executors of Mrs BMG Young (Deceased)

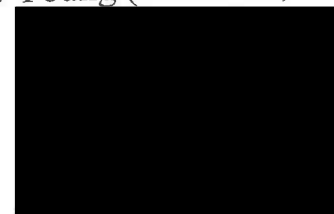

Telephone 

For the attention of Ms Sue Phillips
Dorset County Council, Definitive Map Team.

Dear Ms Phillips

Further to our telephone conversation today I have pleasure in forwarding copies of the maps in my possession which clearly show the bridle ways from the bridge at Rowden Mill Farm as they were when my mother bought the farm. The original map on the conveyance is a copy of a copy and will not photocopy but the map provided by T. McBean is identical in all respects and may even have been taken from the original conveyance map.

It has always been my understanding that the diagonal path came out onto the lane at the point just short of where the boundary of our land is shown.

We have always accepted that users could, if they preferred, go to point A and proceed along Rowden Mill Lane in a northerly direction to reach Stourton Caundle, exiting our property at point B on your map.

I hope this assists the committee in modifying the definitive map.
If I can be of further assistance please contact me.

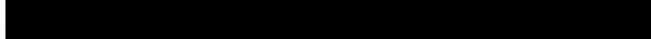

Michael Young.

Email 

ROWDEN MILL FARM, Stourton Caundle:
for: Mrs B.Young.

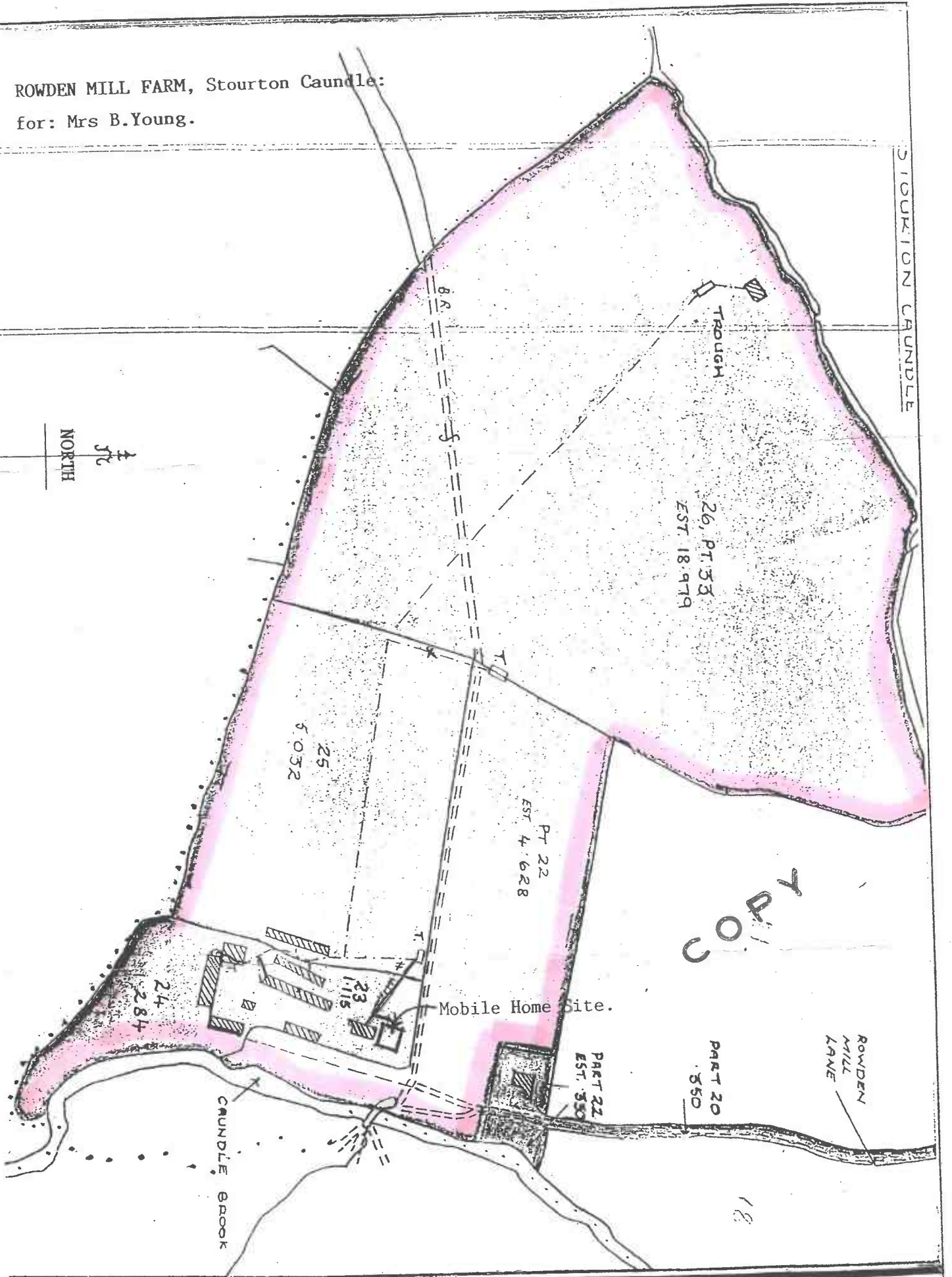

TIMOTHY A.G. MACBEAN
D.Arch.(Hons), Dip. Arch. Cons. R.I.B.A.
Chartered Architect

'Georgian House'
Greenhill
Sherborne
Dorset, DT9 4EP
Tel. S. 814955

Location Plan:

SCALE : 1:2500	DWG NO:
DRAWN: T.McB.	S/1272/LP.
DATE : December 1991.	

EAST ELEVATION

Rowden Mill Lane.

22

23

25

Rowden Mill Farm

23a

24

ET XIIIB.
ION

1/2500

ROSED STORE & COVERED WAY
MRS YOUNG AT THE BUNGALOW
DEN MILL FARM
RTON CAUNDLE

12th Oct 1972



6 October 2022

Your Ref: SP RW/T721

Definitive Map Team
Spatial Planning
County Hall
Colliton Park
Dorchester
DT1 1XJ

Dear Sirs

**WILDLIFE AND COUNTRYSIDE ACT 1981
PROPOSED DEFINITIVE MAP MODIFICATION ORDER – PART OF
BRIDLEWAY 33, STOURTON CAUNDLE (N54/33)**

I write in support of the proposed Order and in response to your letter of 3 October.

I and my family have resided at the above address since September 1981, a total of 41 years. I am a keen walker and during this time I have frequently walked along the roadway shown marked A – B on the plan attached to your letter, in the belief that it was a Public Bridleway. Over the years I have seen many other people walking along this roadway, and riders riding along it.

For most of this time Rowden Mill House was occupied by the late [REDACTED] [REDACTED] who never raised any objection to me, or any other walkers or riders as far as I am aware, using the roadway. The wooden gate at the northern end of the roadway was always kept open.

I have a copy of the 1985 Edition of the Ordnance Survey 1:25000 Pathfinder Map, Sheet ST 61/71, which shows the road A – B marked as a Public Bridleway, with long green dashes. The notes to the map state: "Public rights of way indicated by these symbols have been derived from Definitive Maps as amended by later enactments or instruments held by Ordnance Survey on 1st June 1985". While the representation of a road, track or path is, of course, no evidence of a right of way, it seems very likely that the Definitive Map in force at that date showed the roadway as a Public Bridleway.

I therefore support the proposal that the Definitive Map be modified to show the roadway A – B as part of Bridleway 33.

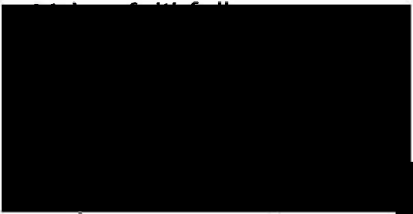

Andrew Oliver



13.10.22	Telephone call	Mr Andrew Oliver – resident. Telephone to thank him for his comments regarding DMO T721. A message left on both landline answerphone and mobile answerphone to relay my thanks for his comments and to make him aware that I would like to ask him if he wishes to be kept informed of the progress of the case. I will attempt to speak with Mr Oliver on another occasion.
----------	----------------	--

17.10.22	Telephone call	Mr Andrew Oliver – following up from last weeks attempt at contact. No answer. Messages left on mobile and landline.
----------	----------------	--

03.11.22	Telephone call [REDACTED]	Mr Andrew Oliver – he called me following my messages in recent weeks. Mr Oliver would like to be notified of the report availability and he gave e his email address: [REDACTED]
----------	------------------------------	---

Susan Phillips

From: Susan Phillips
Sent: 12 October 2022 13:22
To: [REDACTED]
Subject: RE: T721/22/1

Dear Ms Walters

Thank you for your email regarding the Definitive Map Modification Order T721 for Stourton Caundle.

Your comments regarding your knowledge and experience of the route are gratefully received and will be held on file along with other information and comments gathered during the consultation period. At the end of the consultation period a report is written which will include relevant information received from interested parties.

Would you like to be notified when this report is available? Should the answer be 'yes' please be aware that it can take many months between a consultation concluding (which for this particular case is due to be 7th November) and the report being made available. This is due to the potentially lengthy nature of investigations for DMMOs as well as the checking process the report must go through.

Thank you once again for contacting me regarding DMMO T721.

Kind regards
Sue

Sue Phillips
Definitive Map Technical Officer
Definitive Map Team
Economic Growth and Infrastructure
Dorset Council

01305 221409
dorsetcouncil.gov.uk



Dorset Council is a Data Controller for the purposes of the General Data Protection Regulation 2016. This Act regulates how we obtain, use and retain personal information. The information you supply will be used for the purpose of fulfilling our functions and duties, including those under the Highways Act 1980, Town and Country Planning Act 1990 and the Wildlife and Countryside Act 1981. Any information provided, including personal details will be available for public inspection, disclosed to interested third parties and may be used during public inquiries and other proceedings. The information will be kept indefinitely. By replying to this correspondence you are consenting to your personal information being retained and used for these purposes. Further information about the use of personal information and data protection is available on our web-site at www.dorsetcouncil.gov.uk or by contacting the Council's Data Protection Officer.

From: [REDACTED]
Sent: 12 October 2022 13:09
To: Susan Phillips <susan.phillips@dorsetcouncil.gov.uk>
Subject: T721/22/1

Dear Susan

I have lived in Stourton Caundle since April 1993 and have used the road between B and A frequently whilst dog walking.

How else would one access the footbridge BR33 or access BR 6 to walk towards Bishops Caundle?

Yours sincerely

Linda Walters



[Sent from the all-new AOL app for iOS](#)

Susan Phillips

From: Susan Phillips
Sent: 17 October 2022 08:24
To: [REDACTED]
Subject: RE: BRIDLEWAY 33 Stourton Caundle

Dear Nic

Thank you for your email regarding the Definitive Map Modification Order (DMMO) T721 for Stourton Caundle.

Your comments on this route are gratefully received and will be held on file along with other information and comments gathered during the consultation period. At the end of the consultation period a report is written which will include relevant information received from interested parties.

Would you like to be notified when this report is available? Should the answer be 'yes' please be aware that it can take many months between a consultation concluding (which for this particular case is due to be 7th November) and the report being made available. This is due to the potentially lengthy nature of investigations for DMMOs as well as the checking process and potential legal review that the report must go through.

Thank you once again for contacting me with your knowledge of the route for DMMO T721.

Kind regards
Sue

Sue Phillips
Definitive Map Technical Officer
Definitive Map Team
Economic Growth and Infrastructure
Dorset Council

01305 221409
dorsetcouncil.gov.uk



Dorset Council is a Data Controller for the purposes of the General Data Protection Regulation 2016. This Act regulates how we obtain, use and retain personal information. The information you supply will be used for the purpose of fulfilling our functions and duties, including those under the Highways Act 1980, Town and Country Planning Act 1990 and the Wildlife and Countryside Act 1981. Any information provided, including personal details will be available for public inspection, disclosed to interested third parties and may be used during public inquiries and other proceedings. The information will be kept indefinitely. By replying to this correspondence you are consenting to your personal information being retained and used for these purposes. Further information about the use of personal information and data protection is available on our web-site at www.dorsetcouncil.gov.uk or by contacting the Council's Data Protection Officer.

From: [REDACTED]
Sent: 14 October 2022 13:05
To: Susan Phillips <susan.phillips@dorsetcouncil.gov.uk>
Subject: BRIDLEWAY 33 Stourton Caundle

[REDACTED]
[REDACTED]
[REDACTED]

Dear Ms Phillips,

I have lived in Stourton Caundle since 1993. I have used the bridle path between A and B as shown on your Drawing T721-22-1 regularly (at least monthly) over the years when taking various generations of dogs for a walk over the bridge to the left (BR33) or to Holt Lane/Wood (BR 6). I believe the Drawing correctly shows my understanding of the pathway extending from Rowden Mill Lane.

Yours sincerely

Nic Walters

Susan Phillips

From: Susan Phillips
Sent: 17 October 2022 08:16
To: neil gillard
Subject: RE: WILDLIFE & COUNTRYSIDE ACT 1981 - T721 - Stourton Caundle Parish

Dear Mr Gillard

Thank you for your email regarding the Definitive Map Modification Order (DMMO) T721 for Stourton Caundle.

Your comments on this route are gratefully received and will be held on file along with other information and comments gathered during the consultation period. At the end of the consultation period a report is written which will include relevant information received from interested parties.

Would you like to be notified when this report is available? Should the answer be 'yes' please be aware that it can take many months between a consultation concluding (which for this particular case is due to be 7th November) and the report being made available. This is due to the potentially lengthy nature of investigations for DMMOs as well as the checking process and potential legal review that the report must go through.

Thank you once again for contacting me with your knowledge of the route for DMMO T721.

Kind regards
Sue

Sue Phillips
Definitive Map Technical Officer
Definitive Map Team
Economic Growth and Infrastructure
Dorset Council

01305 221409
dorsetcouncil.gov.uk



Dorset Council is a Data Controller for the purposes of the General Data Protection Regulation 2016. This Act regulates how we obtain, use and retain personal information. The information you supply will be used for the purpose of fulfilling our functions and duties, including those under the Highways Act 1980, Town and Country Planning Act 1990 and the Wildlife and Countryside Act 1981. Any information provided, including personal details will be available for public inspection, disclosed to interested third parties and may be used during public inquiries and other proceedings. The information will be kept indefinitely. By replying to this correspondence you are consenting to your personal information being retained and used for these purposes. Further information about the use of personal information and data protection is available on our web-site at www.dorsetcouncil.gov.uk or by contacting the Council's Data Protection Officer.

From: neil gillard [REDACTED]
Sent: 13 October 2022 15:52
To: Susan Phillips <susan.phillips@dorsetcouncil.gov.uk>
Cc: [REDACTED]
Subject: Re: WILDLIFE & COUNTRYSIDE ACT 1981 - T721 - Stourton Caundle Parish

Dear Sue,

I am making this statement in view of the subject proposal, and as invited by your email enclosing the 'to whom it may concern' letter on the subject.

I have been a resident of Stourton Caundle (and one time Parish Councillor) since August 1989. Throughout my 33 years living in this parish, I have walked that part of Bridleway 33 (A to B) which passes Rowden Mill House and connects Rowden Mill Lane to BR 6, BR22 and BR 23 as shown on Drawing T721/22/1. Until the last 2 years there has never been any suggestion that this does not form part of the public right of way, and indeed various historical sources tend to show that this is a very ancient right of way that at one time would have been one of the principal routes into Stourton Caundle. This presumed right of way has been in common use by walkers, runners and riders throughout my time in the village.

In addition, there are many OS maps which clearly show this bridleway between points A and B - these include the 1:25,000 Explorer map 129 from 1997, and the Pathfinder Sheet ST61/71 from 1984 - these are in my possession - and while there is no such clear marking on the 1987 1:50,000 Landranger Sheet 194, I believe that this might well be a question of scale and available space.

In summary, I am certain that this is a long existing right of way which has, at sometime within the last 20 years (and as far as I know without any of the normal consultations), been inadvertently (or otherwise) removed from definitive map, and that it should be restored as proposed.

Yours sincerely,
Neil Gillard

Definitive Map Technical Officer
Definitive Map Team
Economic Growth and Infrastructure
Dorset Council

01305 221409
dorsetcouncil.gov.uk



Dorset Council is a Data Controller for the purposes of the General Data Protection Regulation 2016. This Act regulates how we obtain, use and retain personal information. The information you supply will be used for the purpose of fulfilling our functions and duties, including those under the Highways Act 1980, Town and Country Planning Act 1990 and the Wildlife and Countryside Act 1981. Any information provided, including personal details will be available for public inspection, disclosed to interested third parties and may be used during public inquiries and other proceedings. The information will be kept indefinitely. By replying to this correspondence you are consenting to your personal information being retained and used for these purposes. Further information about the use of personal information and data protection is available on our web-site at www.dorsetcouncil.gov.uk or by contacting the Council's Data Protection Officer.

This e-mail and any files transmitted with it are intended solely for the use of the individual or entity to whom they are addressed. It may contain unclassified but sensitive or protectively marked material and should be handled accordingly. Unless you are the named addressee (or authorised to receive it for the addressee) you may not copy or use it, or disclose it to anyone else. If you have received this transmission in error please notify the sender immediately. All traffic may be subject to recording and/or monitoring in accordance with relevant legislation. Any

views expressed in this message are those of the individual sender, except where the sender specifies and with authority, states them to be the views of Dorset Council. Dorset Council does not accept service of documents by fax or other electronic means. Virus checking: Whilst all reasonable steps have been taken to ensure that this electronic communication and its attachments whether encoded, encrypted or otherwise supplied are free from computer viruses, Dorset Council accepts no liability in respect of any loss, cost, damage or expense suffered as a result of accessing this message or any of its attachments. For information on how Dorset Council processes your information, please see www.dorsetcouncil.gov.uk/data-protection

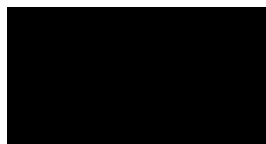

Phone

e-mail:



Ms S Phillips
Definitive Map Technical Officer
Spatial Planning
County Hall
Colliton Park
Dorchester
DT1 1XJ

Your ref: SP RW/T721

21 October 2022

Dear Ms Phillips

**WILDLIFE AND COUNTRYSIDE ACT 1981
PROPOSED DEFINITIVE MAP MODIFICATION ORDER – PART OF BRIDLEWAY 33,
STOURTON CAUNDLE (N54/33)**

Thank you for your e-mailed consultation relating to the above. I am authorised to respond on behalf of the Ramblers, North Dorset Group.

As a Group we have certainly walked the route south along Rowden Mill Lane, to link with the current routes of both N54/33 and N54/6, but I regret I cannot provide any dates, other than to say that it was within the ten years before 2020. We were not challenged, and the route was not obstructed.

Doubtless you will have the evidence in the form of the historic OS Maps, in particular Dorset Sheet XII.NE, Surveyed: 1886, Published: 1887; Dorset Sheet XII.NE Revised: 1901, Published: 1903 and Dorset Sheet XII.NE, Revised: 1927, Published: 1930, which all show at least one route. (Taken from <https://maps.nls.uk/index.html>). I do not have any additional documentary evidence.

I trust that this is of assistance, and thank you for consulting us.

Yours faithfully



Mrs Jan Wardell
Ramblers, North Dorset Group Footpath Secretary

Susan Phillips

From: Susan Phillips
Sent: 02 November 2022 09:10
To: Hedley Walker
Subject: RE: WILDLIFE & COUNTRYSIDE ACT 1981 - T721 - Stourton Caundle Parish

Dear Mr Walker

Thank you for your email regarding the Definitive Map Modification Order (DMMO) T721 for Stourton Caundle.

Your comments on this route are gratefully received and will be held on file along with other information and comments gathered during the consultation period. At the end of the consultation period a report is written which will include relevant information received from interested parties.

Would you like to be notified when this report is available? Should the answer be 'yes' please be aware that it can take many months between a consultation concluding (which for this particular case is due to be 7th November) and the report being made available. This is due to the potentially lengthy nature of investigations for DMMOs as well as the checking process and potential legal review that the report must go through.

Thank you once again for contacting me with your knowledge of the route for DMMO T721.

Kind regards
Sue

Sue Phillips
Definitive Map Technical Officer
Definitive Map Team
Economic Growth and Infrastructure
Dorset Council

01305 221409
dorsetcouncil.gov.uk



Dorset Council is a Data Controller for the purposes of the General Data Protection Regulation 2016. This Act regulates how we obtain, use and retain personal information. The information you supply will be used for the purpose of fulfilling our functions and duties, including those under the Highways Act 1980, Town and Country Planning Act 1990 and the Wildlife and Countryside Act 1981. Any information provided, including personal details will be available for public inspection, disclosed to interested third parties and may be used during public inquiries and other proceedings. The information will be kept indefinitely. By replying to this correspondence you are consenting to your personal information being retained and used for these purposes. Further information about the use of personal information and data protection is available on our web-site at www.dorsetcouncil.gov.uk or by contacting the Council's Data Protection Officer.

From: Hedley Walker [REDACTED]
Sent: 24 October 2022 11:11
To: Susan Phillips <susan.phillips@dorsetcouncil.gov.uk>
Cc: [REDACTED]

Subject: WILDLIFE & COUNTRYSIDE ACT 1981 - T721 - Stourton Caundle Parish

Dear Ms Philips

I am making this statement in view of the subject proposal, and as invited by your email enclosing the 'to whom it may concern' letter on the subject.

I have been a resident of Stourton Caundle since August 2007, and was a Parish Councillor for ten years up until March 2022. I was Chairman at the time when the new occupants of Rowden Mill House first asserted that the route was not a public Right of Way. Throughout our fifteen years living in this parish, my wife and I have walked that part of Bridleway 33 (A to B) which passes Rowden Mill House and connects Rowden Mill Lane to BR6, BR22 and BR23 as shown on Drawing T721/22/1. Until the last two years there had never been any suggestion, by the previous occupant of Rowden Mill House or the occupants of Rowden Mill itself, that it did not form part of the public Right of Way, and I know it has been in common use by walkers, runners and riders throughout my time in the village. Furthermore, the 1:25,000 Explorer map 129 updated in 2004, a copy of which I own, clearly show this bridleway between points A and B.

In conclusion, it appears that this long-existing Right of Way has, at sometime within the last seventeen years, and without any of the normal consultations at least during the time I was a member of the Parish Council, been removed from the definitive map. It should according be restored as proposed.

Yours sincerely.

Hedley Walker

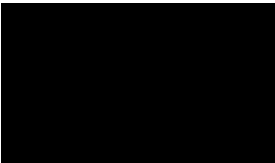

Susan Phillips

From: Susan Phillips
Sent: 02 November 2022 09:13
To: John and Dee Cheesman
Subject: RE: Bridleway 33 Stourton Caundle (N54/33)

Dear Mr and Mrs Chessman

Thank you for your email regarding the Definitive Map Modification Order (DMMO) T721 for Stourton Caundle.

Your comments on this route are gratefully received and will be held on file along with other information and comments gathered during the consultation period. At the end of the consultation period a report is written which will include relevant information received from interested parties.

Would you like to be notified when this report is available? Should the answer be 'yes' please be aware that it can take many months between a consultation concluding (which for this particular case is due to be 7th November) and the report being made available. This is due to the potentially lengthy nature of investigations for DMMOs as well as the checking process and potential legal review that the report must go through.

Thank you once again for contacting me with your knowledge of the route for DMMO T721.

Kind regards
Sue

Sue Phillips

Definitive Map Technical Officer
Definitive Map Team

Economic Growth and Infrastructure

Dorset Council

01305 221409

dorsetcouncil.gov.uk

Dorset Council is a Data Controller for the purposes of the General Data Protection Regulation 2016. This Act regulates how we obtain, use and retain personal information. The information you supply will be used for the purpose of fulfilling our functions and duties, including those under the Highways Act 1980, Town and Country Planning Act 1990 and the Wildlife and Countryside Act 1981. Any information provided, including personal details will be available for public inspection, disclosed to interested third parties and may be used during public inquiries and other proceedings. The information will be kept indefinitely. By replying to this correspondence you are consenting to your personal information being retained and used for these purposes. Further information about the use of personal information and data protection is available on our web-site at www.dorsetcouncil.gov.uk or by contacting the Council's Data Protection Officer.

-----Original Message-----

From: John and Dee Cheesman [REDACTED]
Sent: 31 October 2022 14:26
To: Susan Phillips <susan.phillips@dorsetcouncil.gov.uk>
Subject: Bridleway 33 Stourton Caundle (N54/33)

Dear Ms Phillips

Regarding the notice of proposed modification to the northern end of this bridleway, we would like to state that we have regularly used this route, it forming part of a circular route for us from our home without use of a car. If removed, the route would not be practicable, it involving a very long diversion (in the order of a couple of miles). We have used this bridleway for over 6 1/2 years, and often meet other people on this route. If modification means removal, this would be a great loss of a well used amenity.

Regards,

John and Dee Cheesman

Sent from my iPad

Susan Phillips

From: Clive & Cindee Taylor [REDACTED]
Sent: 02 November 2022 17:32
To: Susan Phillips
Subject: Modification Order (N54/33)
Attachments: Conveyance 1028.jpg; Conveyance 2029.jpg; Right of way 2031.jpg; Right of way030.jpg

Your Ref: SP RW/T721

Ref: Wildlife and countryside act 1981.

Proposed definitive map modification order - part of bridleway 333,
Stourton Caundle (N54/33)

Dear Sue Phillips,

We are writing with regards to the above proposal to modify the definitive map and reinstate the bridleway points A - B shown on your Drawing T721-22-1.

We would like to point out to you that from point 'B' shown on the drawing, up to the small bridge over a water course (grid reference Eastling: 371210.76 Northling: 113790.75) is a private road belonging to Rowden Mill Farm and not a public highway. As such people using the bridleway have no right of way over this section of Rowden Mill Lane making the modified section of the bridleway rather redundant.

When we purchased Rowden Mill House the section of Rowden Mill Lane from Rowden Mill Farm up to the small bridge was clearly marked as a private road belonging to Rowden Mill Farm and we as purchasers of Rowden Mill House had a legal right of way drawn up in the documentation. Unfortunately we do not have our conveyancing paperwork to hand as it is with our solicitor. We do however have copies of two previous conveyances clearly showing the right of way for owners of Rowden Mill House over this section of private road marked in red. This being the property of Rowden Mill Farm on the conveyance maps. We have attached scans of the previous conveyances and the legal right of way granted to purchasers of Rowden Mill House over this section of private road and the agreement to contribute to its maintenance costs.

Regards Mr & Mrs Taylor

Susan Phillips

From: Susan Phillips
Sent: 07 November 2022 08:36
To: Clive & Cindee Taylor
Subject: RE: Modification Order (N54/33)

Dear Mr and Mrs Taylor

Thank you for your email and the information attached regarding Definitive Map Modification Order (DMMO) T721. All evidence that can be offered will help towards the investigation into the apparent drafting error for bridleway N54/33.

The conveyance details you supply support the state of ownership of your property, that of Rowden Mill Farm and access rights affecting both. The existence and status of Public Rights of Way do not affect ownership of property or any access rights that it affords various parties. Modification Orders are not about who owns property or whether private rights of access exist but are to do with Public Rights of Way that give passage to members of the public on foot, horse, bicycle or vehicle (depending on the status of the Public Right of Way). In the case of route N54/33 it has the status of bridleway allowing the public a right of passage on foot, horse and bicycle. To record a public right of way gives that route (in this case N54/33) a legal status. In addition, it is possible for private lanes to also be part of the Highways network which means they are maintainable at public expense, as is the case of Rowden Mill Lane. This is not a consideration of DMMO T721.

The investigation into the apparent drafting error of N54/33 is on going with the public consultation due to close on 7th November. After this the available evidence is summarised in a report that makes a recommendation regarding whether an Order is to be made or not. In the case of T721 the recommendation will either be that a drafting error exists and the route as shown on Drawing T721-22-1 needs to be added back on to the Definitive or it does not exist in which case the currently recorded route of N54/33 will not change. The outcome of the investigation and the subsequent report will not affect the ownership status and any private rights that exist between Rowden Mill Farm (including Rowden Mill Lane) and Rowden Mill House.

I hope the above information has helped clarify the purpose of DMMMO T721.

Kind regards

Sue

Sue Phillips
Definitive Map Technical Officer
Definitive Map Team
Economic Growth and Infrastructure
Dorset Council

01305 221409

[dorsetcouncil.gov.uk](https://www.dorsetcouncil.gov.uk)



Dorset Council is a Data Controller for the purposes of the General Data Protection Regulation 2016. This Act regulates how we obtain, use and retain personal information. The information you supply will be used for the purpose of fulfilling our functions and duties, including those under the Highways Act 1980, Town and Country Planning Act 1990 and the Wildlife and Countryside Act 1981. Any information provided, including personal details will be available for public inspection, disclosed to interested third parties and may be used during public inquiries and other proceedings. The information will be kept indefinitely. By

From: Clive & Cindee Taylor [REDACTED]
Sent: 02 November 2022 17:32
To: Susan Phillips <susan.phillips@dorsetcouncil.gov.uk>
Subject: Modification Order (N54/33)

Your Ref: SP RW/T721

Ref: Wildlife and countryside act 1981.

Proposed definitive map modification order - part of bridleway 333,
Stourton Caundle (N54/33)

Dear Sue Phillips,

We are writing with regards to the above proposal to modify the definitive map and reinstate the bridleway points A - B shown on your Drawing T721-22-1.

We would like to point out to you that from point 'B' shown on the drawing, up to the small bridge over a water course (grid reference Eastling: 371210.76 Northling: 113790.75) is a private road belonging to Rowden Mill Farm and not a public highway. As such people using the bridleway have no right of way over this section of Rowden Mill Lane making the modified section of the bridleway rather redundant.

When we purchased Rowden Mill House the section of Rowden Mill Lane from Rowden Mill Farm up to the small bridge was clearly marked as a private road belonging to Rowden Mill Farm and we as purchasers of Rowden Mill House had a legal right of way drawn up in the documentation. Unfortunately we do not have our conveyancing paperwork to hand as it is with our solicitor. We do however have copies of two previous conveyances clearly showing the right of way for owners of Rowden Mill House over this section of private road marked in red. This being the property of Rowden Mill Farm on the conveyance maps. We have attached scans of the previous conveyances and the legal right of way granted to purchasers of Rowden Mill House over this section of private road and the agreement to contribute to its maintenance costs.

Regards Mr & Mrs Taylor

Susan Phillips

From: Susan Phillips
Sent: 07 November 2022 08:55
To: sarah moss
Subject: RE: Wildlife and Countryside Act 1981: Proposed Definitive Map Modification Order - Part of Bridleway 33, Stourton Caundle (N54/33)

Dear Sarah

Thank you for your email regarding Definitive Map Modification Order – T721 and your knowledge and experience of the route known as N54/33, Stourton Caundle. Your comments have been added to the file and will contribute towards the report that will be produced following the end of the consultation period.

I have added your email address to the contacts list so that you will be notified of the availability of the report in due course.

Kind regards
Sue

Sue Phillips
Definitive Map Technical Officer
Definitive Map Team
Economic Growth and Infrastructure
Dorset Council

01305 221409
dorsetcouncil.gov.uk



Dorset Council is a Data Controller for the purposes of the General Data Protection Regulation 2016. This Act regulates how we obtain, use and retain personal information. The information you supply will be used for the purpose of fulfilling our functions and duties, including those under the Highways Act 1980, Town and Country Planning Act 1990 and the Wildlife and Countryside Act 1981. Any information provided, including personal details will be available for public inspection, disclosed to interested third parties and may be used during public inquiries and other proceedings. The information will be kept indefinitely. By replying to this correspondence you are consenting to your personal information being retained and used for these purposes. Further information about the use of personal information and data protection is available on our web-site at www.dorsetcouncil.gov.uk or by contacting the Council's Data Protection Officer.

From: sarah moss [REDACTED]
Sent: 04 November 2022 14:06
To: Susan Phillips <susan.phillips@dorsetcouncil.gov.uk>
Subject: Wildlife and Countryside Act 1981: Proposed Definitive Map Modification Order - Part of Bridleway 33, Stourton Caundle (N54/33)

Dear Sue

I write in connection with your letter dated 3 October 2022 in relation to the above matter.

Since my family moved to Stourton Caundle in the Summer of 2008 we have both ridden and walked regularly over the years and still do the bridleways available at the bottom of Rowden Mill Lane going both towards Bishops Caundle and towards Stock Gaylard and Woodbridge Farm. We access these bridleways from Rowden Mill Lane passing through the area you describe as the affected area between point "A" and point "B" on the map drawing (ref T721/22/1). Our Ordnance survey map shows this affected area as a Bridleway.

I trust that access along Rowden Mill Lane between points "A" and "B" to these bridleways will exist following your review.

Kind regards

Sarah Moss

Susan Phillips

From: Susan Phillips
Sent: 07 November 2022 09:02
To: Susan Harris
Subject: RE: T721 Consultation Part of Bridleway 33, Stourton Caundle

Dear Mr and Mrs Harris

Thank you for your email regarding the Definitive Map Modification Order (DMMO) T721 for Stourton Caundle.

Your comments on this route are gratefully received and will be held on file along with other information and comments gathered during the consultation period. At the end of the consultation period a report is written which will include relevant information received from interested parties.

Would you like to be notified when this report is available? Should the answer be 'yes' please be aware that it can take many months between a consultation concluding and the report being made available. This is due to the potentially lengthy nature of investigations for DMMOs as well as the checking process and potential legal review that the report must go through.

Thank you once again for contacting me with your knowledge of the route for DMMO T721.

Sue Phillips

Definitive Map Technical Officer
Definitive Map Team

Economic Growth and Infrastructure

Dorset Council

01305 221409

dorsetcouncil.gov.uk

Dorset Council is a Data Controller for the purposes of the General Data Protection Regulation 2016. This Act regulates how we obtain, use and retain personal information. The information you supply will be used for the purpose of fulfilling our functions and duties, including those under the Highways Act 1980, Town and Country

Planning Act 1990 and the Wildlife and Countryside Act 1981. Any information provided, including personal details will be available for public inspection, disclosed to interested third parties and may be used during public inquiries and other proceedings. The information will be kept indefinitely. By replying to this correspondence you are consenting to your personal information being retained and used for these purposes. Further information about the use of personal information and data protection is available on our web-site at www.dorsetcouncil.gov.uk or by contacting the Council's Data Protection Officer.

-----Original Message-----

From: Susan Harris [REDACTED]
Sent: 06 November 2022 20:07
To: Susan Phillips <susan.phillips@dorsetcouncil.gov.uk>
Subject: T721 Consultation Part of Bridleway 33, Stourton Caundle

Dear Sirs

I am writing as a long standing resident of Stourton Caundle, married to someone who was born in the village 72 years ago and grew up in Rowden Mill Lane. My husband has known all the people who lived in Rowden Mill House, a much more recently built dwelling than Rowden Mill farm, and no- one to our knowledge has ever complained before about people walking past the house. I have been here for 50 years and Parish Clerk for about 29 so I know nothing has been raised during this time and we both know the area well.

Surely historically, with the packhorse bridge there and the network of paths from all directions, the lane up to Stourton Caundle must have been well used. There are few places where you can cross the river even now. Imposing a considerable diversion up and down a steep hill seems most unreasonable.

Yours faithfully

Colin and Susan Harris

Sent from my iPhone

Susan Phillips

From: Susan Phillips
Sent: 23 November 2022 14:54
To: Susan Harris
Subject: RE: Bridleway at southern end of Rowden Mill Lane, Stourton Caundle

Dear Susan

Thank you for the email on behalf of Stourton Caundle Parish Council regarding Definitive Map Modification Order (DMMO) – T721 Stourton Caundle. The comments from the Parish Council will be held on file.

The report for the DMMO is being drafted and when it is available, Stourton Caundle Parish Council will be made aware so Parishioners can read the report and its recommendation in full.

Kind regards

Sue

Sue Phillips
Definitive Map Technical Officer
Definitive Map Team
Economic Growth and Infrastructure
Dorset Council

01305 221409

dorsetcouncil.gov.uk



Dorset Council is a Data Controller for the purposes of the General Data Protection Regulation 2016. This Act regulates how we obtain, use and retain personal information. The information you supply will be used for the purpose of fulfilling our functions and duties, including those under the Highways Act 1980, Town and Country Planning Act 1990 and the Wildlife and Countryside Act 1981. Any information provided, including personal details will be available for public inspection, disclosed to interested third parties and may be used during public inquiries and other proceedings. The information will be kept indefinitely. By replying to this correspondence you are consenting to your personal information being retained and used for these purposes. Further information about the use of personal information and data protection is available on our web-site at www.dorsetcouncil.gov.uk or by contacting the Council's Data Protection Officer.

From: Susan Harris <stourtoncaundle@dorset-aptc.gov.uk>
Sent: 21 November 2022 21:21
To: Susan Phillips <susan.phillips@dorsetcouncil.gov.uk>
Subject: Bridleway at southern end of Rowden Mill Lane, Stourton Caundle

Susan Phillips
Definitive Map Technical Officer
Definitive Map Team
Economic Growth and Infrastructure
Dorset Council

Dear Ms Phillips

Re: Bridleway at Southern End of Rowden Mill Lane, Stourton Caundle
Definitive Map Modification Order T721

Dear Ms Phillips

Stourton Caundle Parish Council strongly requests that the omission/error made in the (relatively) recent reiteration of the ROW should be deleted and the former long standing ROW across the packhorse bridge

should be reinstated to preserve the Right of Way between Stourton Caundle and Holwell parish.

O.S. Map 129 clearly shows the bridleway linking Rowden Mill Lane and the undisputed path.

Yours faithfully

Susan Harris
Parish Clerk
Stourton Caundle Parish Council